

# Zero Energy Landmark Tower

## Observatory Museum and Sustainability

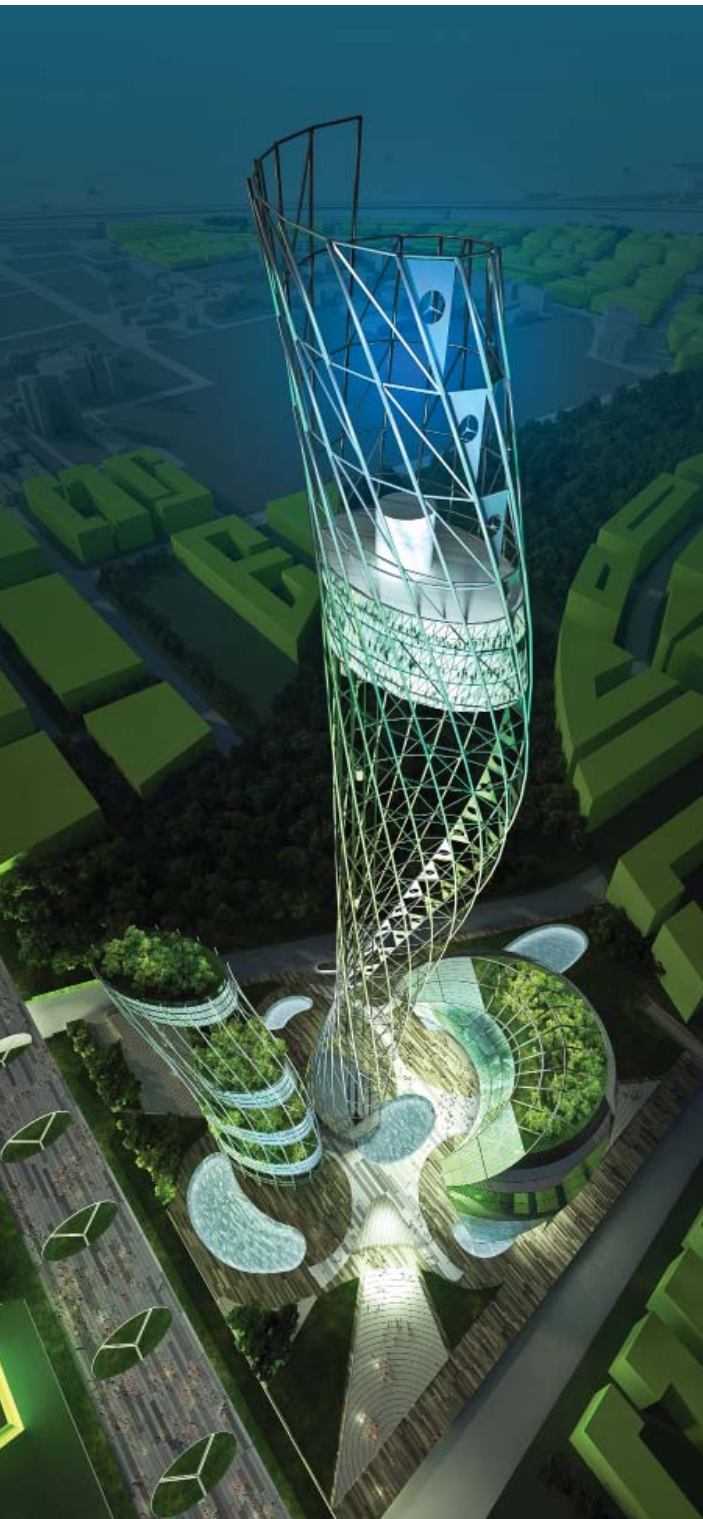

Positive energy and carbon neutral concept design proposal for a 400-meter tall observation and telecommunications tower to be situated at the urban heart of Taizhong City, Taiwan. The strategy for integration of the surrounding ecological community will make use of a centralized district plant and the storage of clean energy and rainwater for off-season water usage. Active geothermal faults below the earth can potentially provide natural hot springs and geothermal power generation for the adjacent ecological communities.

Other clean energy solutions include stack-driven micro-turbines, solar powered Stirling engines, natural ventilation driven by atmospheric pressure differentials, technologies using black-water breakdown and organic digesters for 100% wastewater recycling, and methane generation for efficient fuel cell operations.

The architecture forms a tripartite composition; a curvilinear museum of urban history, green vertical municipal office building, and the public observations tower also serving as communication infrastructure for the City centre. The centrum of composition is in response to the crossing of two urban axes created by the city grid.



The work of LOH ARCHITECTS Associates Inc is focused on bringing a high level of design to institutional and commercial projects. The projects are often undertaken for the most complex building situations where practicality combined with imagination delivers the

final architectural solution. Our innovations solve problems sensibly and our team is dedicated to working with the building owners to deliver lasting aesthetic and functional value, one building at a time. We constantly explore new technologies to augment basic principles of sustainable design such that resultant strategies are effective and cost conscious, contributing to a comprehensive environmental approach to design. We deliver clear overall concepts with artful resolution at every detail level.